



oechsle display systems

reliable and innovative



Exciting Lighting Effects for Shelving:

The new and fascinating shelf dividers with LED-lighting from oechsle: Brilliant lighting effects make your products glow!

Fast and easy installation, adjustable sizes to suit your products and a choice of different colours create the perfect highlights to promote your on-shelf-products.

Display your products with sparkling highlights!

NEW

Light divider
„SPOTLIGHT“

LIGHT DIVIDER „SPOTLIGHT“



oechsle display systems
reliable and innovative

A complete set of light dividers „SPOTLIGHT“ consists of the following components:

T-RAIL

To fix the light dividers at the front shelf edge.
Depending on application requirements use e.g. PRKL, PRT-20-M, etc.

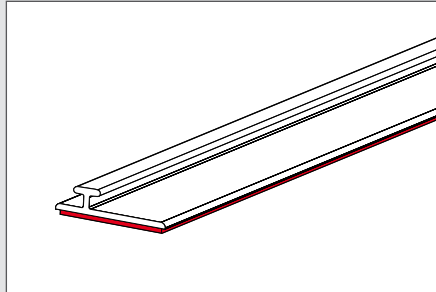
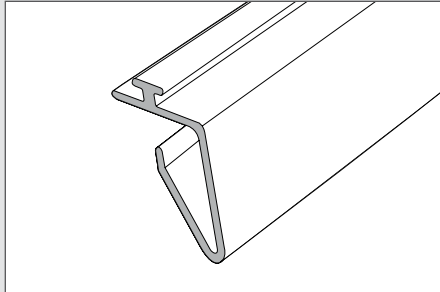

Let's go wild!

Get out more of your shelving
with oechsle „SPOTLIGHTS“!

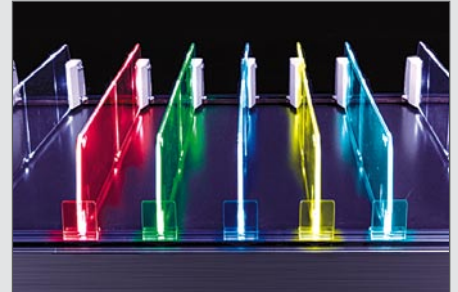

PRT-20-M-LED: CONTACT RAIL WITH MAGNETIC TAPE

For the power supply of the light dividers and fixing at the shelf's rear edge.
1 contact rail per shelf required (length depending on shelf width).

Code-no.
49015-00-LED/0998 (shelf length 1000 mm)
49015-00-LED/1248 (shelf length 1250 mm)



You can create fantastic effects by using various colour foils: Simply put them into the LED-unit – done.

... and the light dividers are sparkling in bright colours!

Choose out of red, blue or green coloured foils.

SHELF DIVIDER PR 60 WITH LED-UNIT

Possible with all shelf dividers system S height 60 mm. We recommend to use max. 18 light dividers per contact rail.

Code-no.
40360-88-LED (shelf depth 370 mm)
40460-88-LED (shelf depth 470 mm)

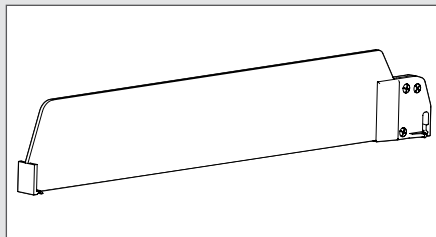

More colours and light dividers in different lengths are available upon request.



SHELF DIVIDER PR 60 WITH LED-UNIT AND CABLE

To plug into the mains adaptor (for the power supply of the contact rail) use 1 divider with cable per shelf.

Code-no.
40360-88-LED (shelf depth 370 mm)
40460-88-LED (shelf depth 470 mm)



We will be pleased to provide you with a specific quotation based on your individual requirements.

Call us!

MAINS ADAPTOR 9V

6-fold connector, for the power supply of up to 6 shelves.
The mains adaptor is GS-approved and with CE-certification.

Code-no.
90-999800



Oechsle Display Systeme GmbH
Bubesheimer Straße 13-15
D-89340 Leipheim
Telefon +49 (0) 82 21 / 27 98-0
Telefax +49 (0) 82 21 / 27 98-27
www.oechsle.de